

PROTECTION OF THE SHAFT: NORM UNI-EN-ISO-13857:2020
FOR PROTECTION WITH METALLIC GRID, USE A COMPACT MESH 10x10mm

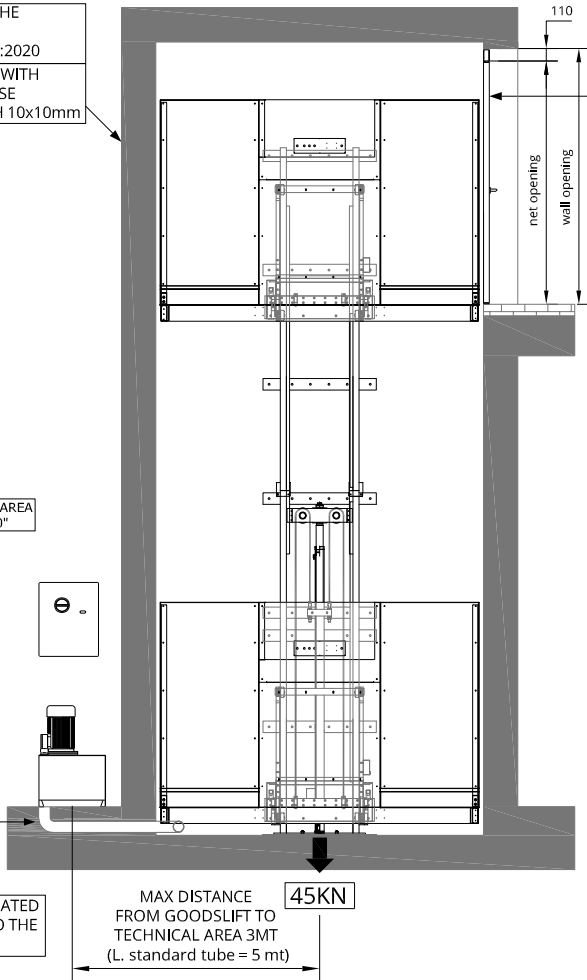

FOR THE DOOR INSTALLATION PLEASE CONSULT THE INSTALLATION MANUAL
MAX 100 mm FROM THE SHAFT

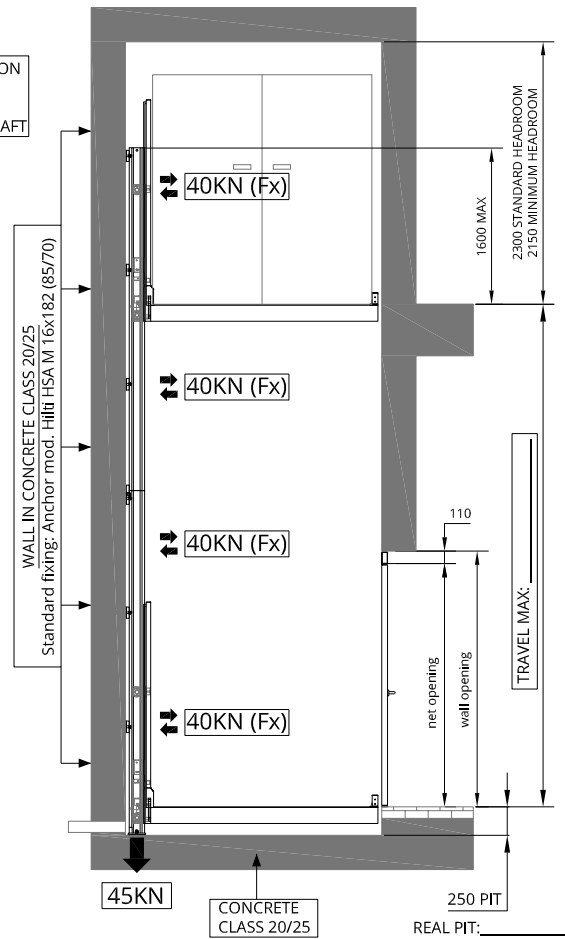

TECHNICAL AREA AT FLOOR "0"

PREPARE CORRUGATED TUBE Ø100mm TO THE TECHNICAL AREA

MAX DISTANCE FROM GOODS LIFT TO TECHNICAL AREA 3MT (L. standard tube = 5 mt)

WALL IN CONCRETE CLASS 20/25
Standard fixing: Anchor mod. Hilti HSA M 16x182 (85/70)

CONCRETE CLASS 20/25

250 PIT

TRAVEL MAX:

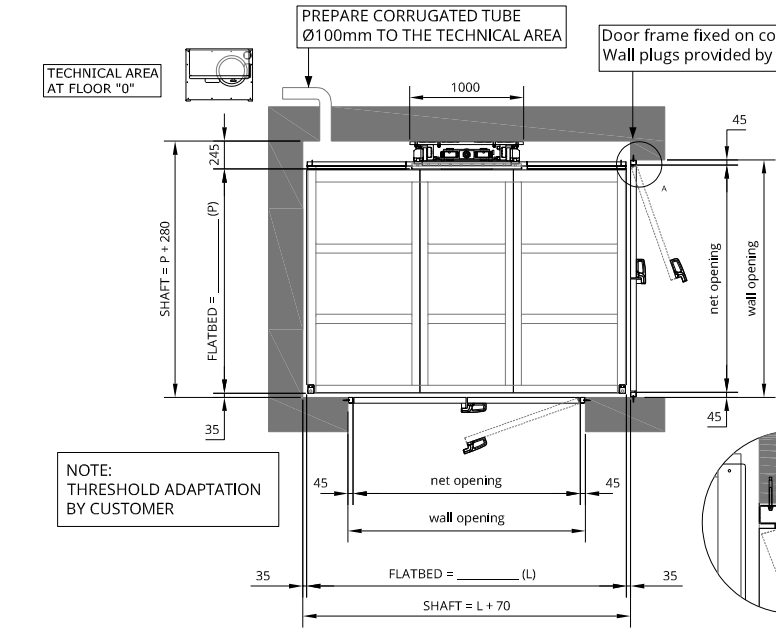

* In order to open the door leaves more than 90° and use the full passage width, the wall thickness must be less than 100mm.

PREPARE POWER FAHNT or 3FAHNT WITH AUTOMATIC MAGNETOTHERMIC WITH DIFFERENTIAL CURVE "C", Id = 0.3A

Motor	Tension-functioning	Starter	Rated current	Starter current
5,5kW	220 V - trifase	Diretto	22	60
	380 V - trifase	Diretto	11	35
7,5kW	220 V - trifase	Diretto	30	90
	380 V - trifase	Diretto	14,5	45
9,2kW	220 V - trifase	Diretto	36	110
	380 V - trifase	Diretto	18	56

MODEL: UP20 - 2000Kg UP25 - 2500Kg

Date: _____ Signature for approval: _____

DIMENSIONS (mm)

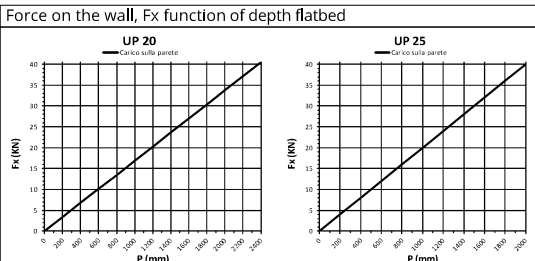
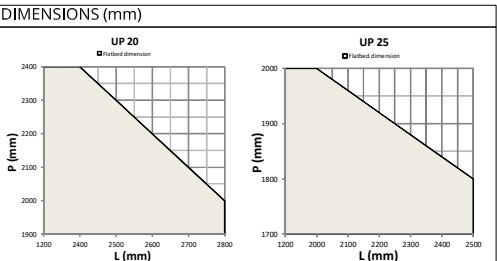

MARK THE ENTRANCES AND THE FLOORS HEIGHTS

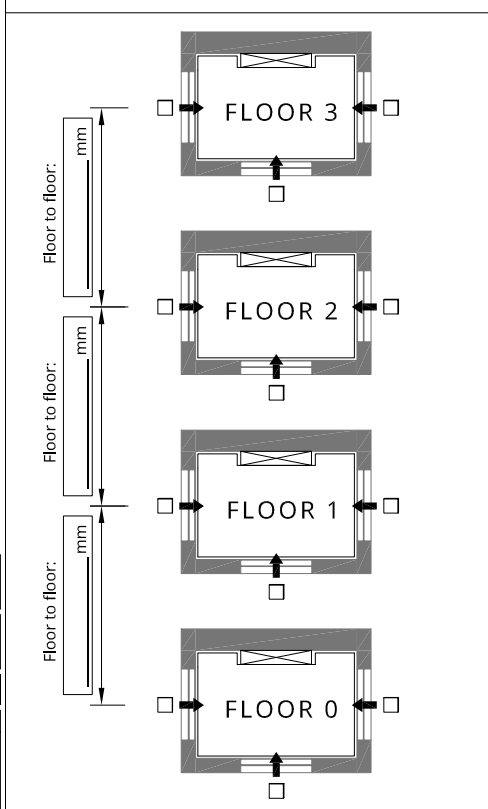

UPDINAMIC Via Modigliani, 22 - 37045 Legnago (VR) - Tel.0442.59.01.29 - Fax. 0442.59.90.91
www.updynamic.com - e-mail: info@updynamic.com

Q.TY DESCRIPTION: Client: _____ Date: 01/01/24
Model: UP20 - 2000Kg UP25 - 2500Kg
Stroke MAX: 16000mm
WITH OPERATOR ON BOARD
TAV-UP2025-SPB01